

ART 126GB

Ductile Iron Butterfly Valve Wafer Type



Features

- Universal flange mounting PN10, PN16, ANSI 150
- BS5155 (BS EN 593)
- ISO 5211 direct mount
- Epoxy coat finish
- MSS-SP-67

Technical data

Max pressure: 16 Bar

Working temp: -10°C to +110°C

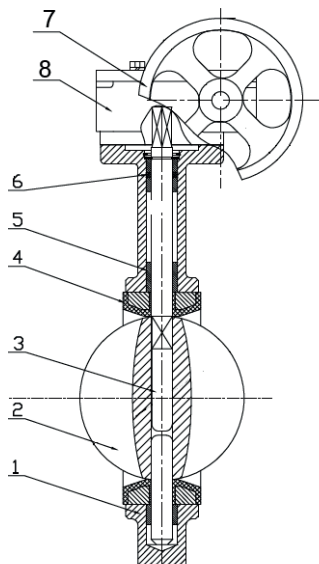

N. Part Name Materials

N.	Part Name	Materials
1	Body	Ductile Iron GGG40
2	Disc	Stainless Steel 316
3	Shaft	Stainless Steel 410
4	Seat	EPDM
5	Bushing	PTFE
6	O-Ring	EPDM
7	Handwheel	Cast Iron
8	Gearbox	Cast Iron

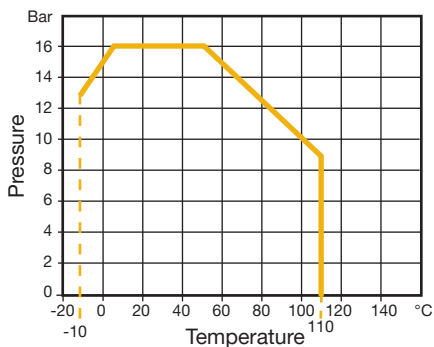

ART 126GB

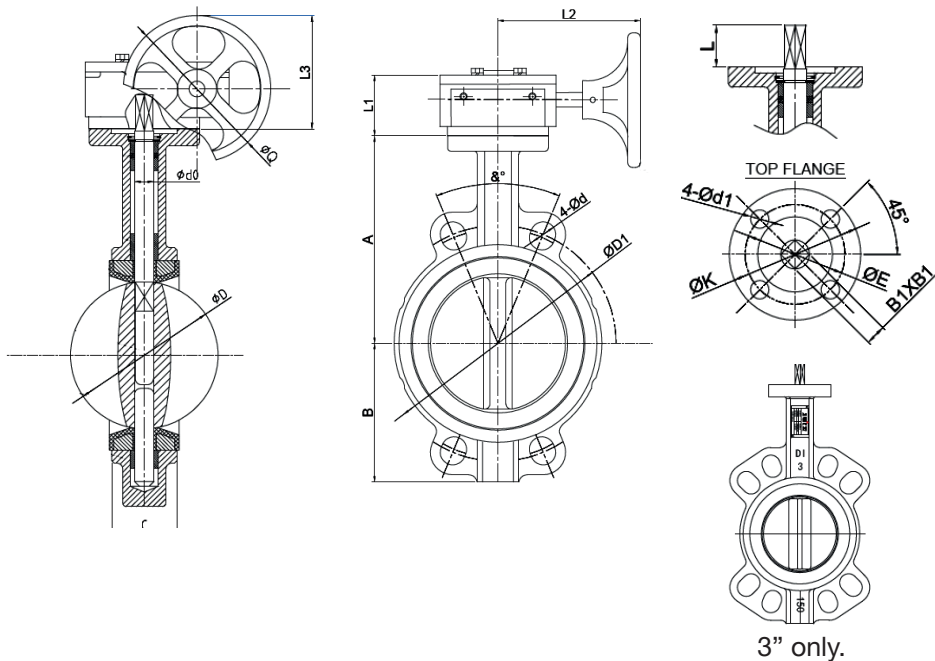

DN	2"	2 1/2"	3"	4"	5"	6"	8"	10"	12"	14"
A	140	150	158	176	190	211	235	265	305	368
B	80	89	95	114	127	139	175	203	242	267
C	42.0	44.7	46.0	52.0	54.4	55.8	60.6	65.6	76.9	76.5
D	52.9	64.5	78.8	104.0	123.3	155.1	202.5	250.5	301.5	333.3
D1 PN10/PN16	125	145	160	180	210	240	295	350/355	400/410	460/470
D1 ANSI 150	120.5	139.5	152.5	190.5	216.0	241.5	298.5	362.0	432.0	476.5
E	50	50	50	70	70	70	102	102	102	102
4- ϕd PN10/PN16	4-19	4-19	4-19	4-19	4-19	4-23	4-23	4-23/28	4-23/28	4-23/28
4- ϕd ANSI 150	4-19	4-19	4-19	4-19	4-22.5	4-22.5	4-22.5	4-25.5	4-25.5	4-28.5
L	26	26	26	28	28	28	36	36	38	42
L1	62	62	62	62	62	62	76	76	75	75
ϕ	90	90	45/45/90	45	45	45	45/30/45	30	30	22.5/ 22.5/30
d0	12.6	12.6	12.6	15.8	18.9	18.9	22.1	28.5	31.6	31.6
ISO 5211	F05	F05	F05	F07	F07	F07	F10	F10	F10	F10
K	65	65	65	90	90	90	125	125	125	125
4- ϕd_1	4-7	4-7	4-7	4-10	4-10	4-10	4-12	4-12	4-12	4-12
B1	9	9	9	11	14	14	17	22	22	22
L1	62	62	62	62	62	62	76	76	75	75
L2	156	156	156	156	156	156	208	208	186	186
L3	106.5	106.5	106.5	106.5	106.5	106.5	178.5	178.5	177	177
Q	147	147	147	147	147	147	278	278	278	278