

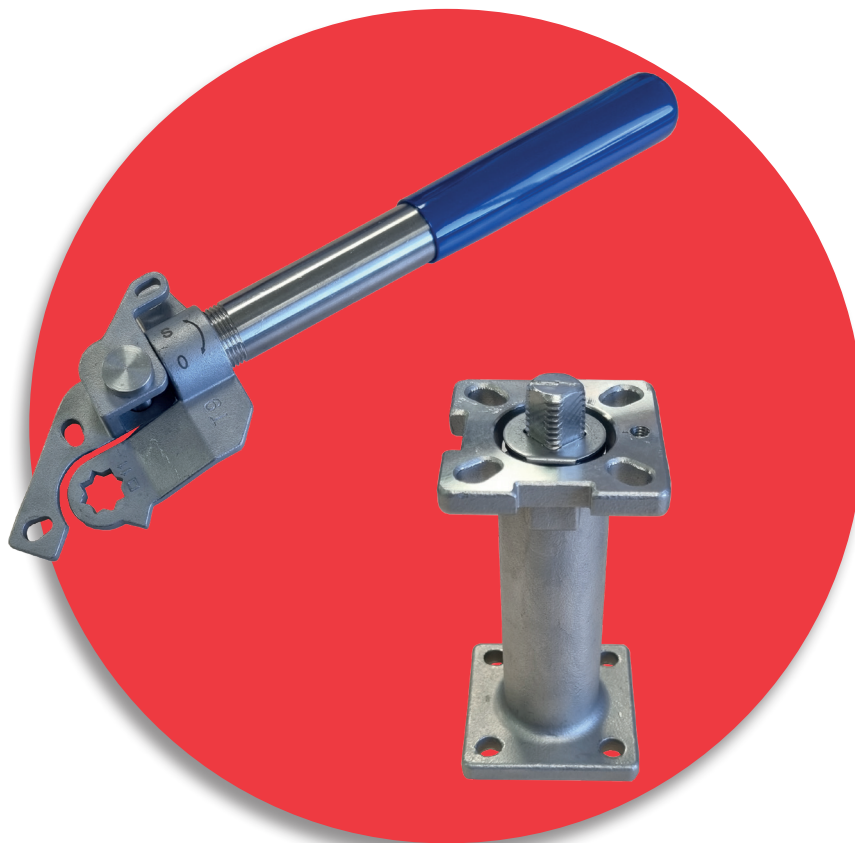

Installation & Operating Manual



SS Accessories

Albion Valves (UK) Ltd
www.albionvalvesuk.com
Email: sales@albionvalvesuk.com
Tel: 01226 729900



Contents

1. Introduction
2. Technical Data
3. Valve Installation
 - 3.1 ART 97M Installation
 - 3.2 DMH Installation
4. Troubleshooting
5. Warranty

1. Introduction

- The purpose of this document is to provide installation and operational instructions for the below listed accessories.
- A complete risk assessment should take place prior to work commencing.

2. Technical Data

Accessory Type	Connection Type	Valve Suitability
ART 97M	ISO 5211	ART 993H, 994, 995, 926, 956, 928, 958, 924, 987, 988, 997, 998
ART DMH	ISO 5211	ART 993H, 994, 995, 926, 956, 928, 958, 924, 987, 988, 997, 998

Please refer to the individual data sheets for full technical specifications.

3. Valve Installation

- Albion Valves (UK) Ltd recommend that the installer adheres to the installation requirements as specified by the Water Supply Water Fittings Regulations 1999.
- It is the responsibility of the installer to ensure the valve and accessory are suitable for service conditions e.g., temperature, pressure, and service media.
- Care should be taken to ensure the surface finish of the valve and accessory are protected during installation. Any damage to the valve surface may cause metallic corrosion.
- The valves may be installed in horizontal pipework with sealing materials and the stem in the vertical position, or in vertical pipework with the stem horizontal.
- Suitable gaskets should be used during installation.
- It is the responsibility of the installer to ensure that the valve and accessory and adjoining pipework are suitably supported.

- Bolt tightening must be even and diagonal around the valve face to prevent any alignment distortion. Further details regarding bolting sequences can be found on Albion Valves (UK) Ltd's website.

3.1 ART 97M installation

- Ensure the correct size stainless steel extension has been selected for the ISO pad on the valve. This can be identified by matching the marking on the valve ISO pad with the marking on the extension piece.
- In order to install the stainless steel extension piece, the handle on the valve must be removed first, this can be done using an appropriately sized spanner, the handle should now slide off the stem. The stop pin on the valve also needs to be removed, this can simply be done by using a flat head screwdriver and screwing it out, the extension piece can now be installed, see Fig.2.
- The stainless steel extension piece must be lined up with the holes on the ISO pad, using the nuts and bolts provided, the extension piece should be fastened to the valve, once secured, the blue cap on the extension stem can be removed and the original handle can be re-installed using the appropriately sized spanner and the stop pin re-installed at the correct position.
- Finally, a check should be completed to ensure the stainless steel extension piece is safely secured onto the valve, and an operational test should be carried out to ensure the valve is functioning as required.

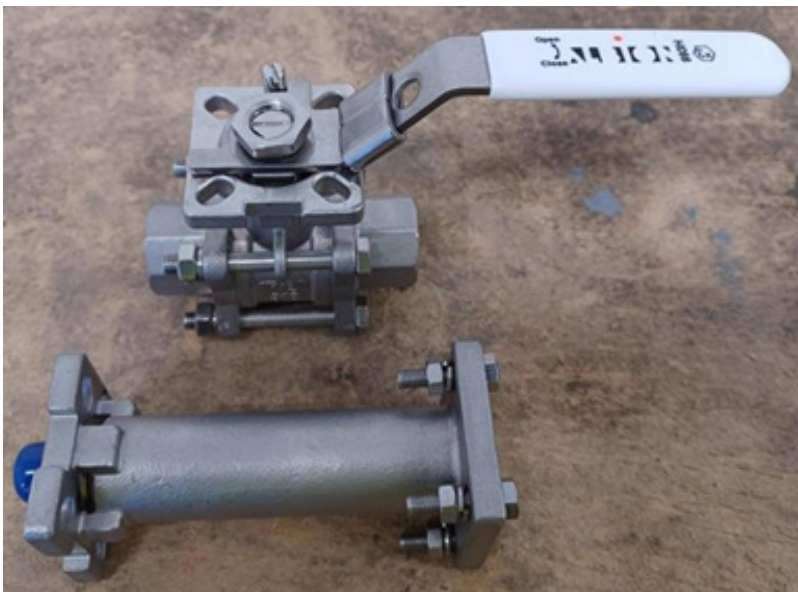

Fig.1



Fig.2 - Handle and stop pin removed
From valve



Fig.3 – Fully assembled valve and extension piece

3.2 ART DMH (Dead Mans Handle) Installation

- Ensure the correct size Dead Mans Handle (ART DMH) has been selected for the ISO pad on the valve. This can be identified by matching the marking on the valve ISO pad with the marking on the extension piece.
- In order to install the DMH, the handle on the valve must be removed first, this can be done using an appropriately sized spanner, the handle should now slide off the stem. The stop pin on the valve also needs to be removed, this can simply be done by using a flat head screwdriver and screwing it out, see Fig.2, the DMH can now be installed.
- The DMH should be aligned as shown in Fig.5, once aligned, slide the DMH onto the stem and secure it with the original nut on the valve, the DMH is supplied with two additional nuts and bolts, these must be installed to secure the DMH in place, see Fig.6.
- Finally, a check should be completed to ensure the DMH is safely secured onto the valve, and an operational test should be carried out to ensure the valve and DMH is functioning as required.

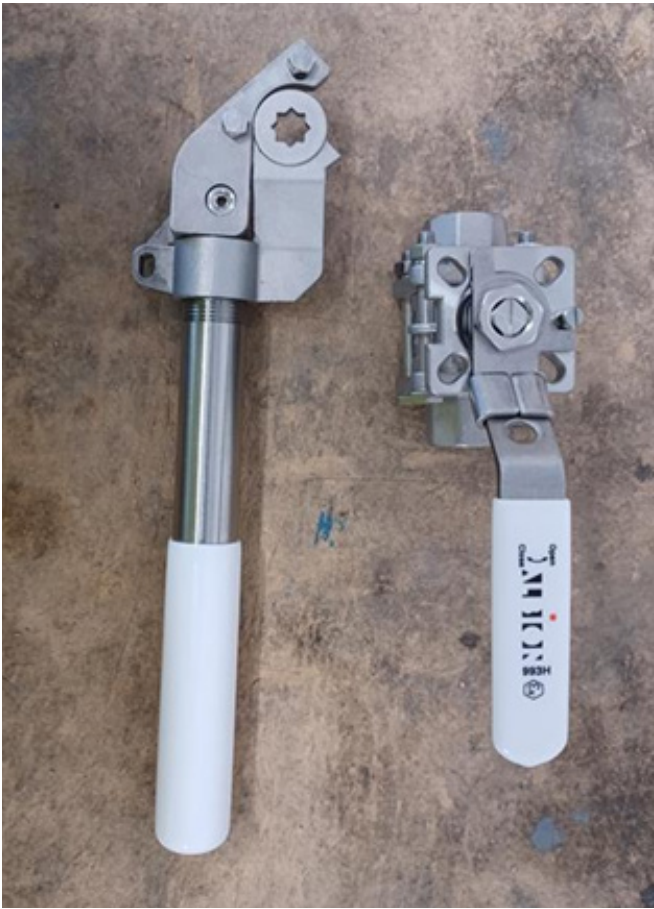

Fig.5

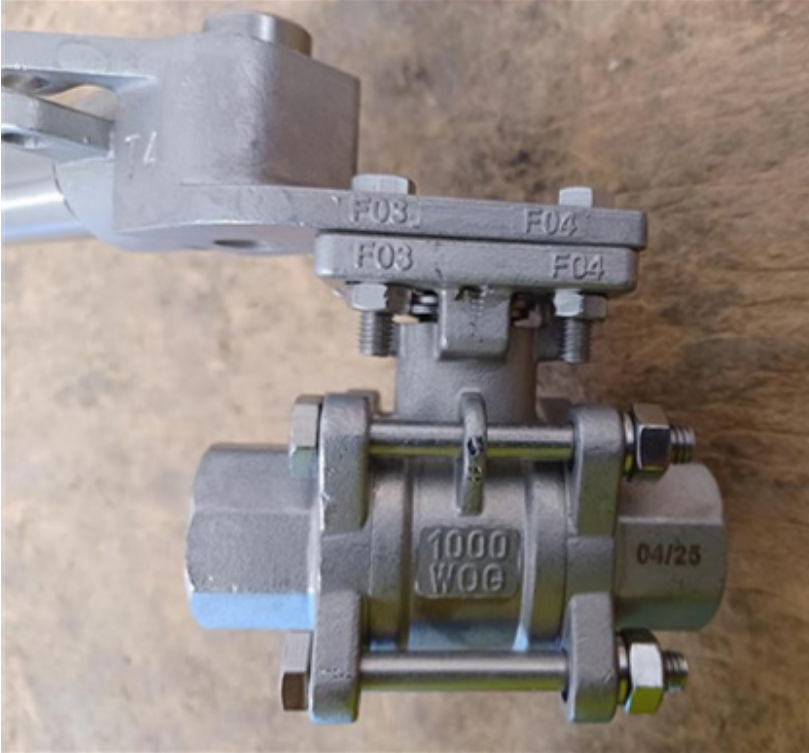

Fig.6



Fig.7



4. Troubleshooting

- If any maintenance is to be undertaken on Albion Valves (UK) Ltd's range of Valves it is the responsibility of the installer to ensure the system is adequately drained, depressurised and the valve isolated before any work commences.
- A full risk assessment should be undertaken prior to any works taking place.

5. Warranty

- For further details of Albion Valves (UK) Ltd warranty period, please refer to Albion Valves (UK) Ltd 'Conditions of Sale' available on our website.



About Albion Valves (UK) Limited

Albion Valves (UK) Limited has been in the industrial heating and valve market for over 40 years, with this comes a wealth of knowledge and expertise that allows us to support our network of independent distributors and their customers.

Albion aims to supply a readily available, complete, quality valve solution alongside excellent cradle-to-grave support and service.

That is why we say, 'It's all at Albion'.

Quality

Whatever you need, you can rest assured that if it comes from Albion it has been designed and manufactured to deliver optimum performance and is accredited with the necessary approvals. Our in-house quality and technical departments are always on hand too!

Service

Our cradle-to-grave approach means you will never be on your own. Whether you need assistance with your system designs, an industry-leading turnaround time on your quote, or some help with commissioning after installation, we have a team to help!

Delivery

We know that time is money, and when a priority project depends on a part, you can trust Albion to deliver. We deliver 95% of products the next day with 99.98% accuracy!

Choice

We may have started with a single brass ball valve, but our range has grown substantially since and we can now offer a full building services valve solution, alongside a comprehensive range of valves for the industrial and process markets.

It is becoming more and more apparent to the industry, that it really is, all at Albion.